



HELMAC

weighing food machines • retail data systems

A RICE LAKE WEIGHING SYSTEMS COMPANY



PROFESSIONAL
WRAPPERS

W M

Official distributor



www.helmac.com





THE MOST COMPACT



LARGE
FILM



SMALL
FILM



NO
WASTE



CAMERA FOR
TRAY DETECTION

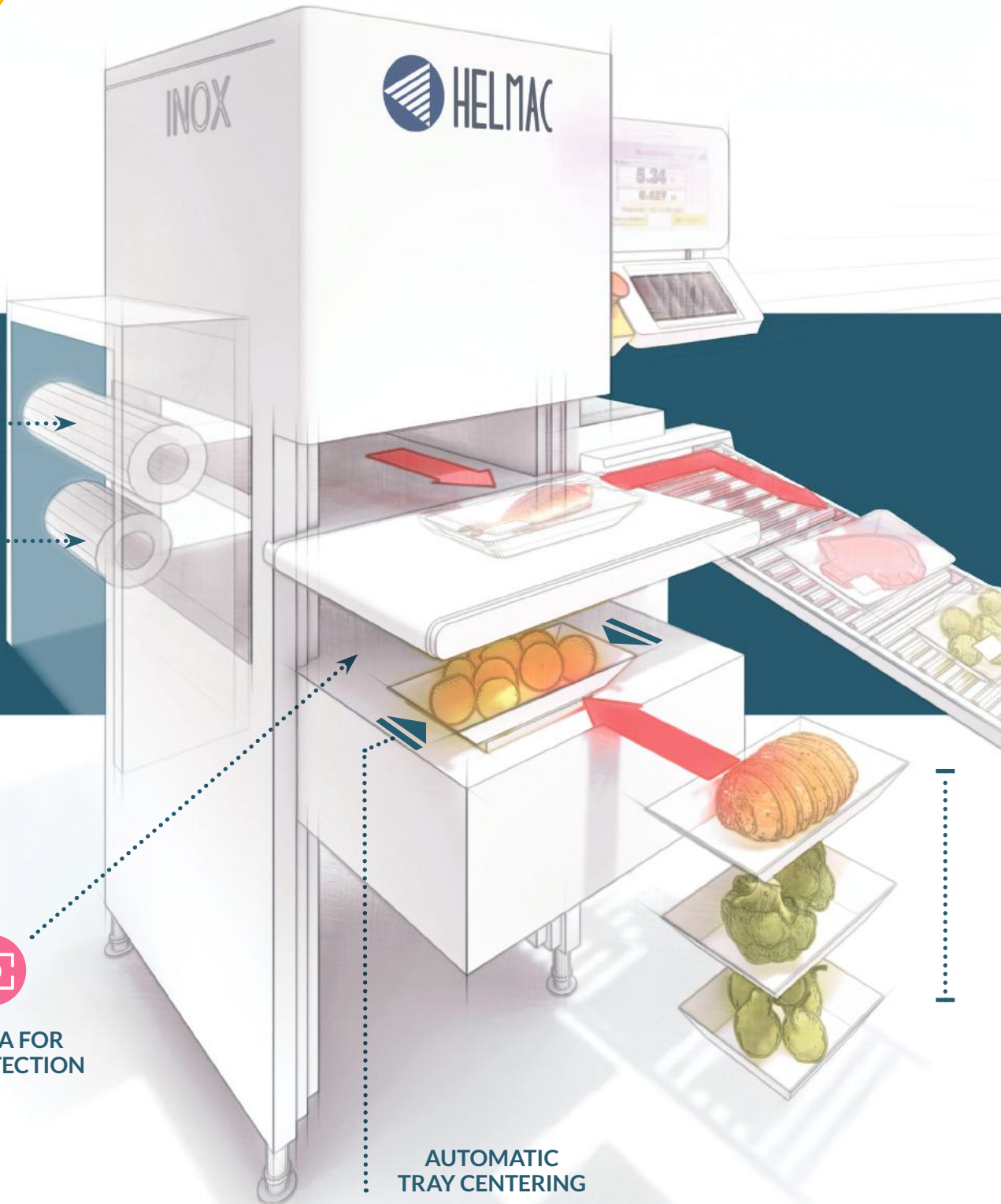

AUTOMATIC
TRAY CENTERING

Automatic wrapping machine in stainless steel that **weighs, wraps and labels** up to 35 trays per minute, particularly suitable for deli, meat and produce department.

LABEL



The position and angle of the label application is configurable with the type of tray.

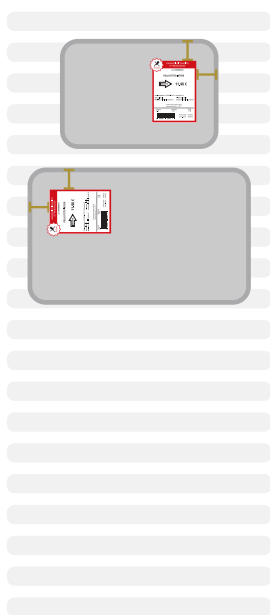

LABEL + PROMO

Application of additional promotional label, pre-printed or with customizable print.

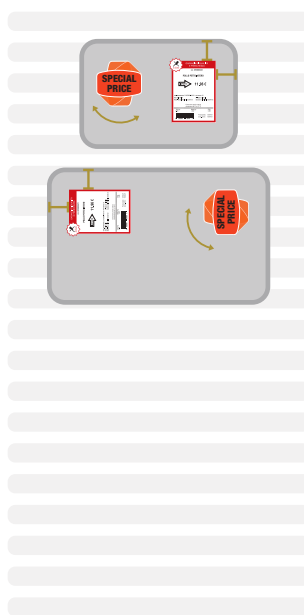

ETICHETTA VARIABLE + PROMO

Management of two labels of different sizes with customizable graphics and application and printing of promotional label (PROMO).

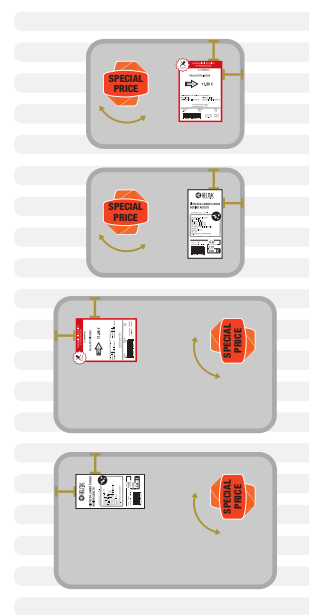

PRECISE AND FAST LABELING
thanks to the automatic applicator



TRAYS OF DIFFERENT DIMENSIONS



WM AI is the only wrapping machine equipped with 2 reels.

The machine chooses the most suitable film according to the size of the tray. This makes it possible to wrap different formats with considerable savings in terms of material and time.

Compact Size



- Always efficient wrapping in a minimum of space

12" Touch Screen Display



- Fully configurable with many functions
- Multiple statistics on wrapped goods

Tray Detection and Centering



- Always centered tray
- Tray size recognition
- Faster entry for the operator

Film Reels: 1 or 2



- Material saving
- Automatic film selection



Printers: 1 or 2



- Management of labels of various sizes
- Customizable texts, graphics and angle
- Easy roll replacement thanks to the pull-out drawer

Applicator of Promotional Labels

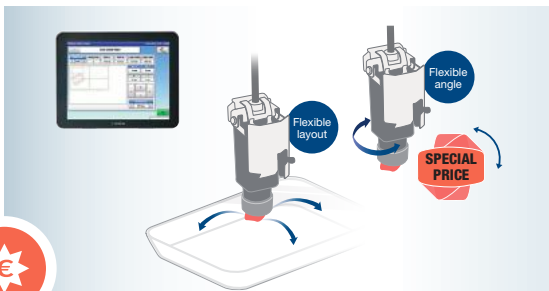

- Integrated printer for label customization
- Configurable angle and position

Automatic Applicator



- Extremely precise application for trays of any size

Output Roller Conveyor



- Integration into production line

Input Belt Conveyor











- Maximum wrapping speed
- Simultaneous work of several operators

S E R I E S WM-AI

Comparative Table



	WM-AI AS1	WM-AI ASP1P	WM-AI AS2 JR	WM-AI AT2 JR
 Dimensions	122x164x112 cm	122x164x112 cm	122x164x155 cm	122x164x155 cm
 12" Touch screen display	✓	✓	✓	✓
 Tray detection	✓	✓	✓	✓
 Reels	1	1	2	2
 Printers	1	2	1	2
 Automatic applicator	✓	✓	✓	✓
 Output roller conveyor			✓	✓
 Applicator of promotional labels		✓		
 Input belt conveyor				



WM-AI AS2 JRP	WM-AI AT2 JRP	WM-AI AS2 JRP+PSAI	WM-AI AT2 JRP+PSAI
122x178x155 cm	122x178x155 cm	148x178x251 cm	148x178x251 cm
✓	✓	✓	✓
✓	✓	✓	✓
2	2	2	2
1	2	1	2
✓	✓	✓	✓
✓	✓	✓	✓
✓	✓	✓	✓
		✓	✓

SERIES WM- NANO



7"
TOUCH



Weighing:

Dual-range
(6/15 Kg x 2/5 g)

Can be connected to
the main management
softwares available on the
market



TRAYS

- Packaging trays of different materials and shapes
- Speed up to 16 pieces per minute
- Packaging capacity:
up to 3500 g
- Labelling capacity:
up to 15 kg



DISPLAY

- Customisable 7-inch touch screen
- Keypad with 84 customisable keys



LABELLING

- 2" label printer
- Ultra-fast roll changeover system
with removable front drawer
- Up to 7 drawers that can be
connected to different layouts and
screens

Connectivity, functionality and integration

The WM-AI and Nano packaging machines can be easily integrated into existing installations as they can be interfaced with any management system

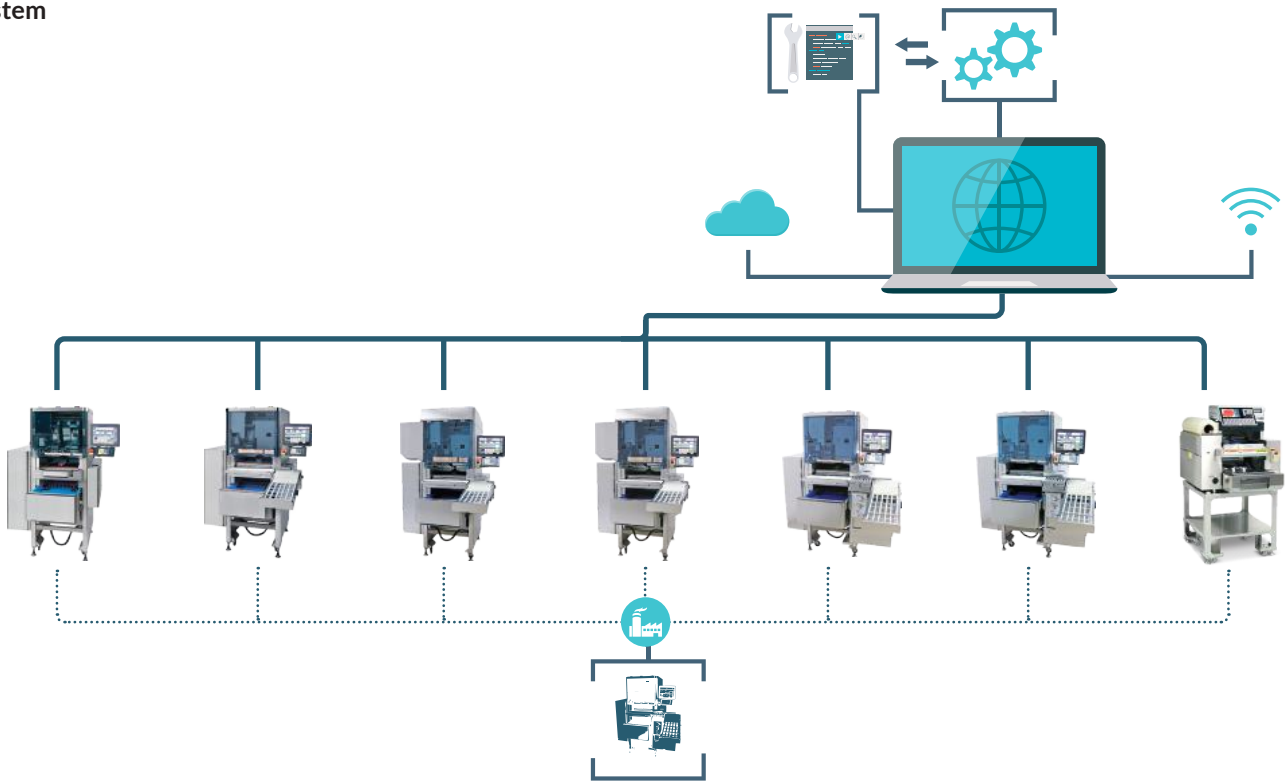

BENEFITS FOR THE CUSTOMER

✓
No changes to the existing
system

✓
Synchronised update of items
and ingredients

✓
Control over sold products and
traceability

Environment and sustainability

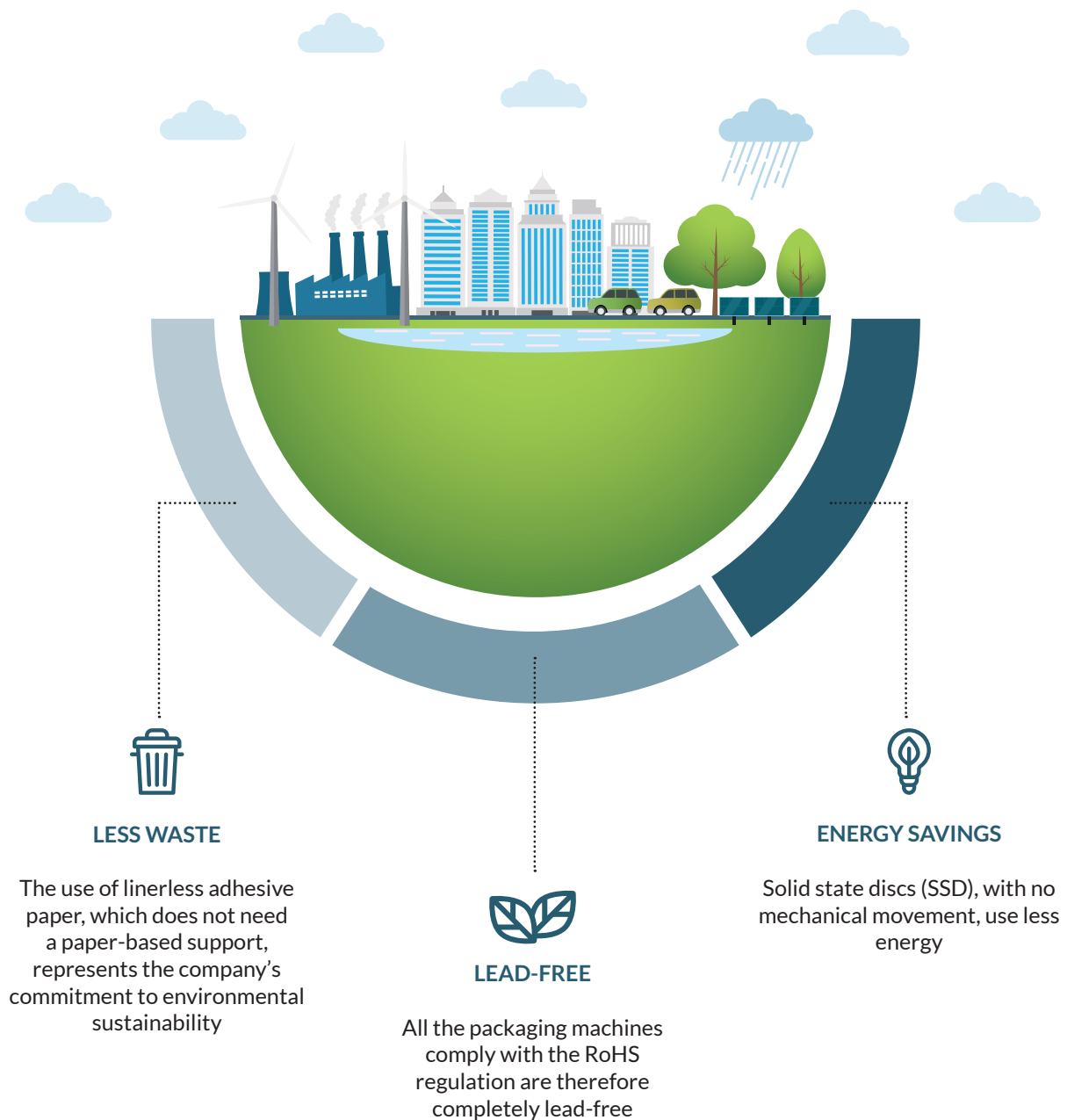

YOUR
WORLDWIDE
PARTNER
FOR RETAIL
SOLUTIONS



Via della Fisica, 18 - 41042 Fiorano Modenese (MO) Italy - Tel. +39 0536 070960

www.helmac.com

SALES AND TECHNICAL SUPPORT SERVICE

Mod **HCONF - EN**

P/N 
HCONF - EN

Sn 
NOSN

HCONF - EN/NOSN



Rev. 17/01/2023

